

PLANNED TREE MAINTENANCE

Tree Works Notification		Created By:	
Public Scrutiny		Date:	
Tree Works reference number and schedule title			
Wards included within planned works:			
Abbey		East Chesterton	Queen Ediths
Arbury		Kings Hedges	Romsey
Castle		Market	Trumpington
Cherry Hinton		Newnham	West Chesterton
Coleridge		Petersfield	
Within following Council service areas:			
Highways		Housing	Parks
Size of schedule – based on number of trees included within:			
Small (< 10 trees)		Medium (11 - 50 trees)	Large (> 50 trees)
Brief description of the works			

Tree Works Notification

For tree works submitted under a 'Tree Works Notification' I refer you to Policy GM3 of the Cambridge City Council Citywide Tree Strategy 2016-2026 Part 2:

"All planned tree works will be published on the Council website and through site notices for the community to access at least 20 working days before implementation. The council sees this as an important tool for communicating to the local community about tree work planned for their area and the reasons why the works are necessary." <https://www.cambridge.gov.uk/tree-strategy>

The notification period will run for 20 days from the date of publication of the schedule.

The majority of the works contained within these schedules consists of minor pruning to address health and safety issues, or more significant works to remove trees that are obviously dead, dying or diseased, or replacement planting for trees that have been removed.

A brief outline of the planned works can be found in the table shown above however; full details of the planned works can be found within the attached schedules and maps.

Please note: where trees are due to be felled, these are marked on site with green tape.

Public Scrutiny

For tree works submitted for 'Public Scrutiny' A brief outline of the planned works which we wish to be publicly scrutinised can be found within the attached schedules and maps which will be available for ten working days following the date of publication.

The planned works could involve either removing healthy trees over 75mm in diameter as measured at 1.5m above ground level and/or any tree work or batch of works that will have a significant impact on the landscape character of an area as assessed by an arboricultural officer. This will include crown reductions of over 30% in branch length on trees that have not previously been reduced.

The table above provides details of the works which are open for public scrutiny, please note that some tree works schedules may contain other works in other service areas than those open to this level of scrutiny. The following details only relate to the significant works considered for scrutiny. Please note: where trees are

due to be felled, these are clearly marked on site with green tape.

I refer you to Policy GM5 of the Cambridge City Council [Citywide Tree Strategy 2016-2026 Part 2](#):

“When considering tree works on City Council land, the Council will invite resident and stakeholder comment regarding the following kinds of work:

- a) Any tree work which will have a significant impact on the character of an area.*
- b) Felling healthy trees of over 75mm diameter”*

If you wish to make a comment about any of the works proposed, please submit them via this link: [Comment on a tree work schedule](#). All unresolved objections to tree work subject to public scrutiny will be determined by the relevant Executive Councillor.

Location:

PMP Crematorium

Site type:

Order no/ref:

Contract/Client Ref:

Item created: 05 September 2025

Priority of works:

Start on/after:

Complete by:

Tree/Item code	Species/Work required	Rate	Quantity	Cost
----------------	-----------------------	------	----------	------

Crematorium (CREMAT), South Cambs

Sgl/4 (512212)	Ash (Common) (Fraxinus excelsior) (///power.vocab.dark) CRT C/R - by 3-4m		1 tree	0.00
Exposed area of sapwood on trunk. Old prune wounds decaying back into tree. Tree has suffered from wind throw as it has lost top of its crown. All this area has extensive decay with signs of brown flux water down the trunk.; Heavily reduce crown / repollard, leaving lower branches to die back and dsczy for wildlife.;				
Sgl/5 (512216)	Ash (Common) (Fraxinus excelsior) (///pretty.asks.spits) CRP C/R - repollard		1 tree	0.00
Sgl/7 (523008)	Elm (Unspecified) (Ulmus species) (///damage.employ.cans) RT1 Remove tree leaving 1m high stump dead tree		1 tree	
Sgl/8 (523016)	Elm (Unspecified) (Ulmus species) (///visits.slime.will) RT1 Remove tree leaving 1m high stump dead tree		1 tree	
Sgl/12 (515860)	Poplar (Aspen) (Populus tremula) (///farm.mute.deal) CRHG C/R - height by 3m		1 tree	0.00
Sgl/50 (513112)	Prunus (Fastigate Cherry) (Prunus x hillieri 'Spire') (///asks.span.extra) CL2.5 Crown lift to 2.5m		1 tree	
Sgl/51 (513084)	Lime (Unspecified) (Tilia species) (///image.riches.joke) CRT C/R - by 1-2m RDW Rem - deadwood		1 tree 1 tree	0.00 0.00
Sgl/97 (512312)	Aesculus (Horse Chestnut) (Aesculus hippocastanum) (///pushes.salon.rents) CLF C/L - over footpath to 2.4m		1 tree	0.00
Sgl/98 (512292)	Willow (Golden Weeping) (Salix x sepulcralis var. chrysocoma) (///pile.ducks.excuse) CRT C/R - by 3-4m		1 tree	0.00
Sgl/121 (512380)	Aesculus (Horse Chestnut) (Aesculus hippocastanum) (///chop.union.social) CRB C/R - to clear building by 1m		1 tree	0.00

Tree/Item code	Species/Work required	Rate	Quantity	Cost
Sgl/130 (514088)	Willow (Golden Weeping) (Salix x sepulcralis var. chrysocoma) (((honey.flash.headed))			
CRT C/R - by 2-3m			1 tree	0.00
Sgl/136 (512996)	Larch (European) (Larix decidua) (((kick.bottle.moving))			
SSIVY Sever and strip ivy up to 1 metre above ground level			1 tree	
Sgl/137 (513000)	Birch (Silver) (Betula pendula) (((clip.tube.vouch))			
SSIVY Sever and strip ivy up to 1 metre above ground level			1 tree	
Sgl/138 (513004)	Larch (European) (Larix decidua) (((flown.exit.pilots))			
SSIVY Sever and strip ivy up to 1 metre above ground level			1 tree	
Sgl/184 (513432)	Poplar (Unspecified) (Populus species) (((spike.shave.bunk))			
CRT C/R - by removing the deadwood			1 tree	0.00
Sgl/185 (513428)	Poplar (Unspecified) (Populus species) (((straw.ends.forget))			
CRT C/R - by removing the deadwood			1 tree	0.00
Sgl/204 (513444)	Willow (Unspecified) (Salix species) (((wool.filer.desks))			
CL3 Crown lift to 3m			1 tree	
Sgl/211 (514096)	Willow (Unspecified) (Salix species) Salix myrsinifolia (((fire.agree.plates))			
CRT C/R - by 3-4m			1 tree	0.00
Sgl/218 (512920)	Lime (Unspecified) (Tilia species) (((trip.wisdom.claps))			
CLF C/L - over footpath to 2.4m			1 tree	0.00
Sgl/221 (512908)	Prunus (Japanese Cherry Cv.) (Prunus serrulata 'Kanzan') (((grows.struck.flags))			
RFR Rem - tree for replant			1 tree	0.00
Sgl/235 (512812)	Yew (Irish) (Taxus baccata 'Fastigiata') (((habit.novel.even))			
RFR Rem - tree for replant			1 tree	0.00
Sgl/240 (512744)	Beech (Common) (Fagus sylvatica) (((casino.clip.reach))			
CL3 Crown lift to 3m			1 tree	
Sgl/279 (514080)	Willow (Golden Weeping) (Salix x sepulcralis var. chrysocoma) (((nasal.desk.dish))			
CRT C/R - by 4-5m			1 tree	0.00
RDW Rem - deadwood			1 tree	0.00
Sgl/283 (512552)	Ash (Common) (Fraxinus excelsior) (((taped.kept.brings))			
RDW Rem - deadwood over footpath			1 tree	0.00

Tree/Item code	Species/Work required	Rate	Quantity	Cost
Sgl/335 (512388) ICR Sever and strip all ivy growth from tree	Poplar (Aspen) (Populus tremula) (///issued.target.zooms)		1 tree	
Sgl/347 (512828) CRHG C/R - height by 1.5m	Poplar (Unspecified) (Populus species) (///gross.answer.jolly)		1 tree	0.00
Sgl/361 (512764) RFR Rem - tree for replant	Sorbus (Rowan) (Sorbus aucuparia) (///bumpy.runner.pencil)		1 tree	0.00
Sgl/367 (512956) RFR Rem - tree for replant	Birch (Silver) (Betula pendula) (///transmitted.healers.stuck)		1 tree	0.00
Sgl/369 (512968) BRANC Reduce specified branch by reduce vertical primary branch on northwestern side by 2-3m. This is facing the car park, with the Woodpecker holes in the stem.	Poplar (Aspen) (Populus tremula) (///dots.that.invite)		1 tree	
Sgl/370 (514092) CRX C/R - to previous reduction points	Willow (White) (Salix alba) (///tent.taker.snail)		1 tree	0.00
Sgl/431 (800039) RFR Rem - tree for replant	Sorbus (Rowan) (Sorbus aucuparia) (///agents.costs.drives)		1 tree	0.00
Sgl/440 (800048) RT1 Remove tree leaving 1m high stump dead tree	Poplar (Aspen) (Populus tremula) (///robot.league.crab)		1 tree	
Sgl/441 (800051) BRANC Reduce specified branch by reduce primary branch extending towards the A14 by 6 to 8 meters. this will give clearance to road signs and create a new Pollard point	Willow (White) (Salix alba) (///shrimp.spoke.stuck)		1 tree	
Sgl/442 (800052) CRC C/R - to clear A14 road sign by 3-4m	Willow (White) (Salix alba) (///aside.issued.cubes)		1 tree	0.00
Sgl/443 (800053) RDW Rem - deadwood	Ash (Common) (Fraxinus excelsior) woodland area (///shadow.hurls.cure)		1 tree	0.00
Sgl/445 (800055) CLT C/L - to 1m	Birch (Kashmir) (Betula utilis var. jacquemontii) (///oppose.define.times)		1 tree	0.00
Sgl/446 (800056) CLT C/L - to 1m	Birch (Kashmir) (Betula utilis var. jacquemontii) (///value.author.case)		1 tree	0.00
Sgl/447 (800057) CLT C/L - to 1m	Birch (Kashmir) (Betula utilis var. jacquemontii) (///soils.duty.comical)		1 tree	0.00

Tree/Item code	Species/Work required	Rate	Quantity	Cost
Sgl/448 (800058) CLT C/L - to 1m	Birch (Kashmir) (Betula utilis var. jacquemontii) (///signal.family.papers)		1 tree	0.00
Sgl/449 (800059) CLT C/L - to 1m	Birch (Kashmir) (Betula utilis var. jacquemontii) (///signal.family.papers)		1 tree	0.00

â€¢ Basic inspection of all trees undertaken at this site. Significant issues and / or works recorded where appropriate against relevant tree.Â Â Sit was inspected on two dates 6.3.20 and 9.3.20-10.3.20

Expenditure code analysis :-

Expenditure code not specified

Schedule item analysis :-

CLF	C/L - over footpath to 2.4m	2 trees @ 0.00
CLT	C/L - to	5 trees @ 0.00
CRB	C/R - to clear building by	1 tree @ 0.00
CRC	C/R - to clear	1 tree @ 0.00
CRHG	C/R - height by	2 trees @ 0.00
CRP	C/R - repollard	1 tree @ 0.00
CRT	C/R - by	8 trees @ 0.00
CRX	C/R - to previous reduction points	1 tree @ 0.00
RDW	Rem - deadwood	4 trees @ 0.00
RFR	Rem - tree for replant	5 trees @ 0.00

Contractor:

Total cost: 0.00

Issued by:

Kenny McGegeor

ARBORICULTURAL WORKS ORDER

Item Ref: 02463

Crematorium (CREMAT), South Cambs

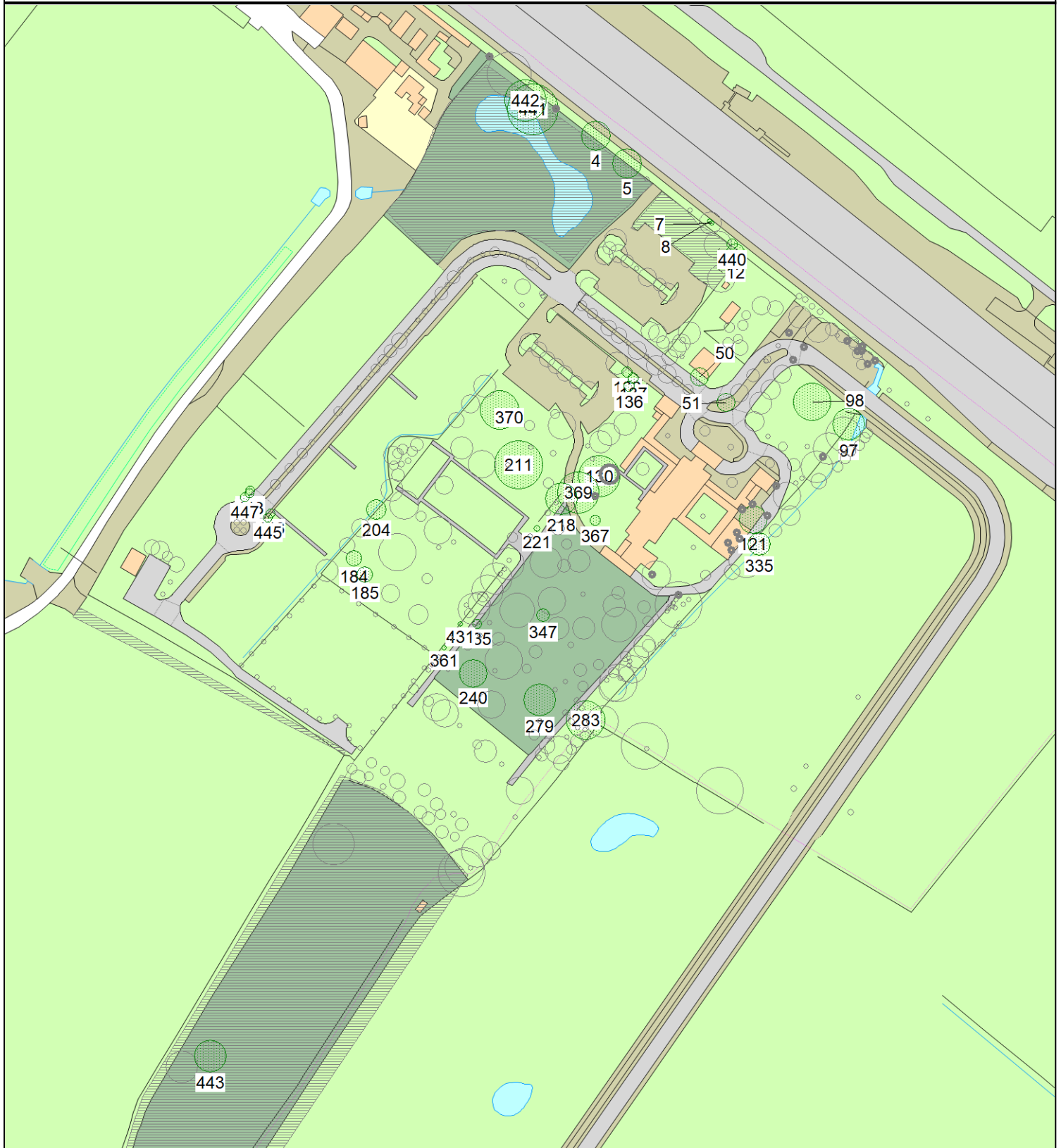

This map is reproduced from Ordnance Survey material with the permission of Her Majesty's Stationery Office (c) Crown copyright.
Unauthorised reproduction infringes Crown copyright and may lead to prosecution or civil proceedings." Cambridge City Council (Licence No. 100019730)
2006.